

PRELIMINARY FILL LIMIT MAP GRAND POINT NORTH

RENO, NEVADA
OCTOBER, 2022

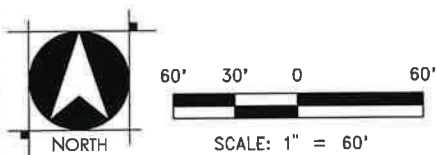
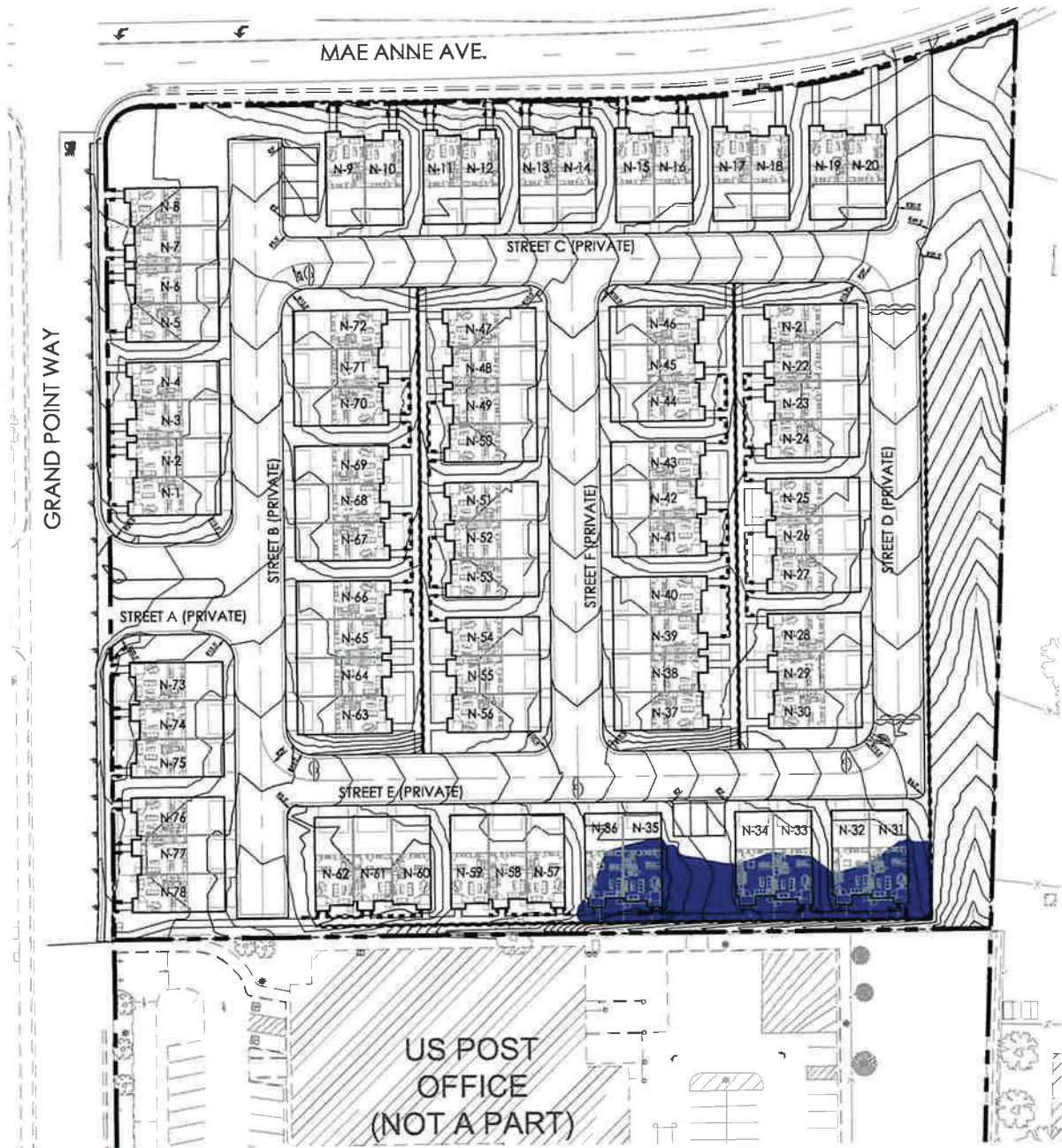

LEGEND

- FILL AREA GREATER THAN 10 FEET
(16' MAX FILL DEPTH)

WOOD RODGERS
BUILDING RELATIONSHIPS ONE PROJECT AT A TIME
1361 Corporate Boulevard Tel 775.823.4068
Reno, NV 89502 Fax 775.823.4068

GRAND POINT TOWNHOMES NORTH

TENTATIVE MAP PRELIMINARY GRADING PLAN

